



Help for Today ... Hope for Tomorrow

Giving Hope a Home

Dream it.

Wish it.

Do it.

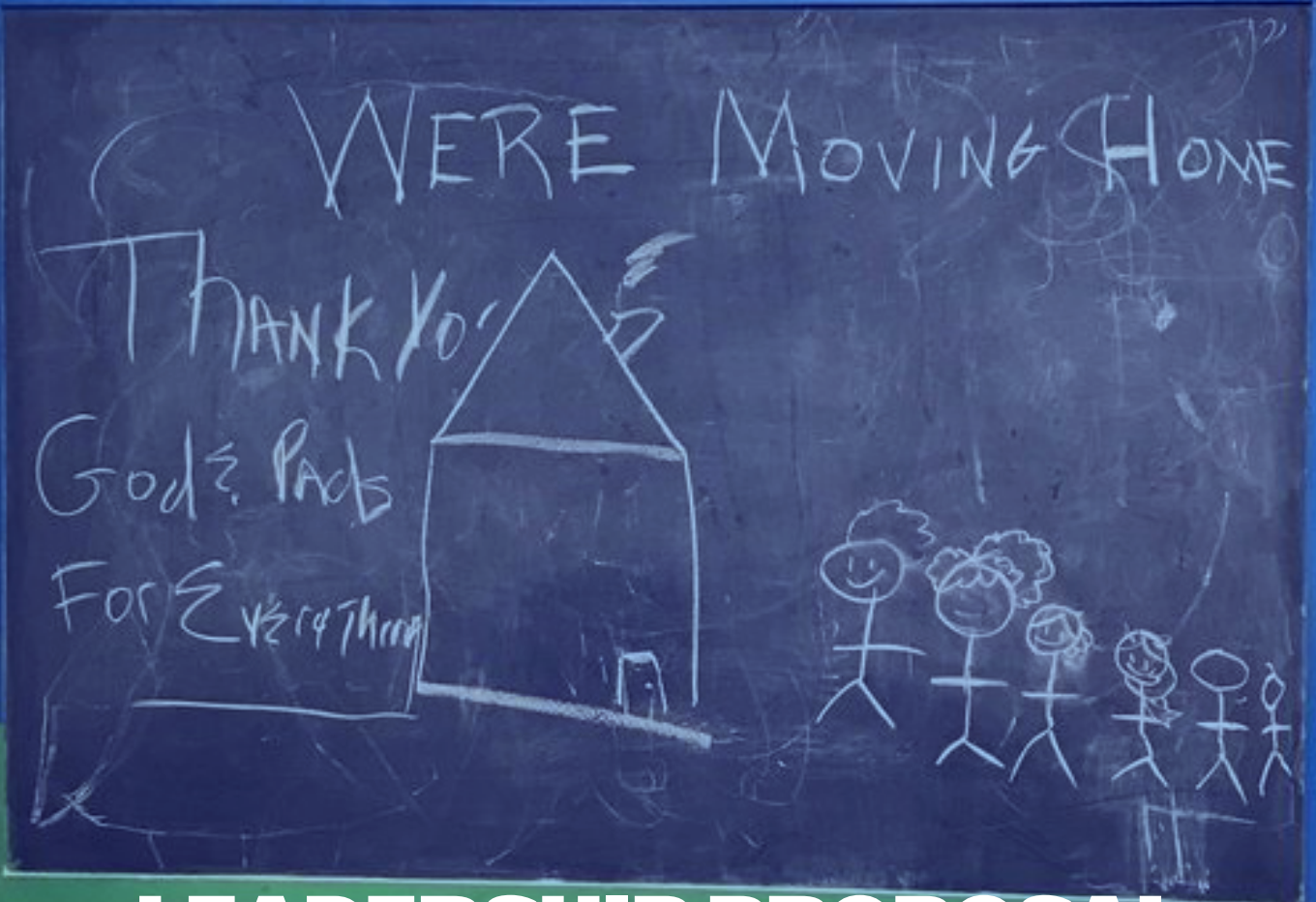

LEADERSHIP PROPOSAL

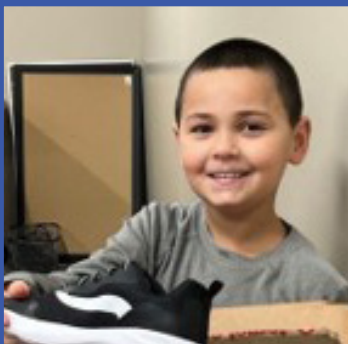
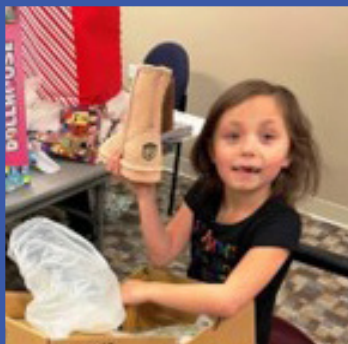

ILLINOIS VALLEY PADS

Illinois Valley PADS traces its origins back to 1991 when it emerged as a grassroots response to homelessness and adversity within our community. What began humbly, with the provision of a bedding pad on the floors of churches and community spaces, has evolved into a beacon of hope and support for the homeless individuals and families of LaSalle, Bureau, and Putnam Counties in North Central Illinois.

Today, Illinois Valley PADS stands as a vital lifeline, offering safe shelter, showers, nourishing meals, and access to life-changing services to homeless men, women, and children in our region. Central to our mission is the steadfast commitment to uphold the dignity and compassion of those experiencing homelessness, recognizing their inherent worth and humanity amidst challenging circumstances.

At our two permanent shelters located in Peru and Ottawa, we extend a warm embrace to the most vulnerable members of our community, providing not only a safe refuge from the elements but also support aimed at empowering our guests to reclaim their independence and self-sufficiency. Through dedicated case worker services focused on employment, life skills, housing, and fostering a renewed sense of purpose, Illinois Valley PADS serves as a catalyst for positive change—a vital stepping stone on the path to independent living.

OUR IMPACT

In FY 2023, we served 492 individual clients and in FY 2022, have already served 375 clients — the highest number of any year in our history.

The poverty rate within families, particularly children, is alarmingly high and increasing. This adversely impacts education, nutrition, housing, safety, and sense of self-worth. The elderly population over age 65 is also impacted by low income. Despite the many resources that address the elderly in our communities, such as housing projects and in-home assistance, there are still many elderly community members who become homeless.



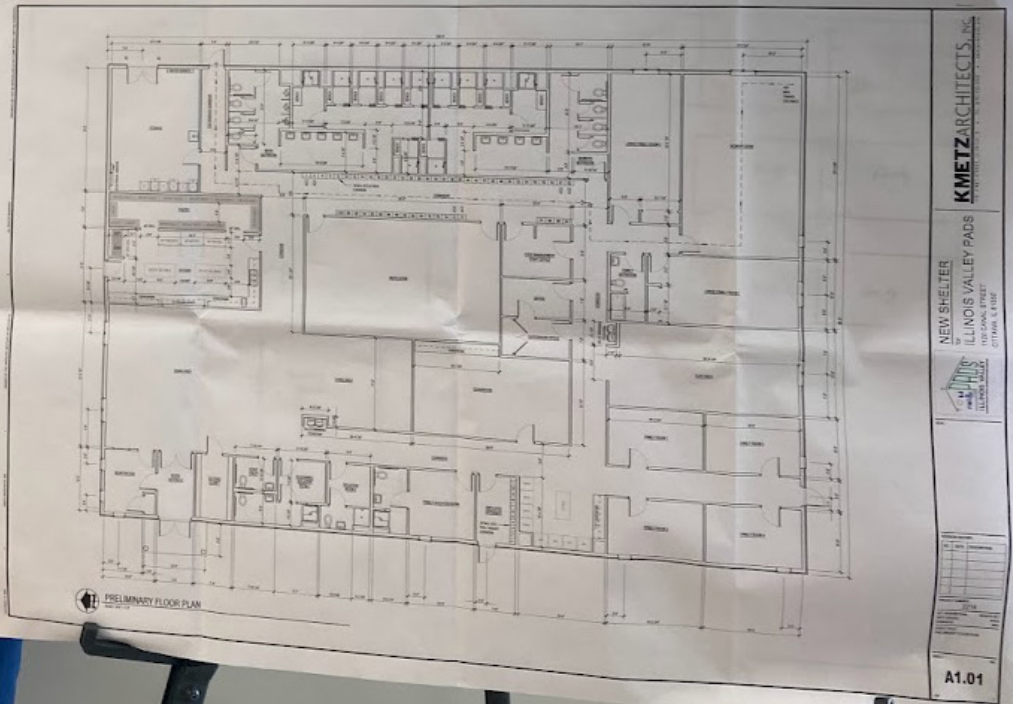

OUR NEEDS:

It's time ... yes; it's time to build a new shelter - a space that reflects our community's commitment to compassion, dignity, and support. This new facility will not only address the shortcomings of the current building but will also pave the way for expanded services, increased capacity, and a more welcoming environment for those in need.

Why now?

Deteriorating Conditions: The current shelter's infrastructure is no longer adequate to ensure the safety and well-being of those seeking refuge and safety and, additionally, for the safety for our staff. Crumbling walls, buckling floors, inadequate washing and bathroom services, and outdated facilities all hinder our ability to offer the care and dignity every individual deserves.

Overcrowding: The demand for shelter services has risen dramatically, surpassing the capacity of our existing facility.

Limited Resources: Operating within the constraints of our current building hampers our ability to provide the most basic of services and access to support programs.



WHAT OUR NEW FACILITY WILL PROVIDE:

Increased space	The new 11,264 square foot shelter built on our current property would double our available space
Commercial kitchen	The integration of a commercial kitchen would empower the shelter to seamlessly address the escalating demand for meals
Larger dorm rooms	Larger dorm rooms for both men and women will increase our capacity to 100 beds
Family rooms	The addition of six dedicated family rooms will offer families a sense of privacy and security, fostering an environment conducive to their well-being. Establishing such family-oriented spaces significantly enhances the success rates of individuals transitioning towards self-sufficiency
Larger bathrooms with Showers	The new shelter would have two larger bathrooms equipped with showers. These facilities would adequately support our current demand and allow for future expansion
Multi-purpose classroom	A classroom will serve as a hub for essential life skills training, support group sessions, and employment training programs. These resources are indispensable in facilitating the transition towards self-sufficiency for our guests
Playroom area	A designated playroom area will provide a supervised space for interaction, growth, and physical activity
Isolation rooms	Several rooms with self-contained bathrooms would be used to house individuals who need to isolate due to infectious viruses.
Office and storage space	The new facility would provide additional office and storage space to support case management staff



MEET OUR BOARD OF DIRECTORS:

Front (from left to right):

Joanne Sheldon; Pat Applebee, *Vice President*;
Mary Jo Urbanski, *Secretary*; Gerilyn Hocking, *President*

Back (from left to right):

Chris Drewel; Ken Brown, *Treasurer*;
Bob Hylin; Tom Rooney; Bob Piercy



**ILLINOIS VALLEY PUBLIC ACTION
TO DELIVER SHELTER**

(IV PADS)

PO Box 1012

LaSalle, IL 61301

ivpads.com

info@ivpads.com